

Concerning Compact Discs



Only compact discs bearing this mark can be used with this unit.

However, continued use of irregular shaped CDs can damage the unit.



How to remove a disc from its case

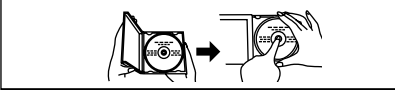

How to store the disc in its case



How to hold a disc



If the surface is dirty

Wipe it with a damp cloth and then wipe dry. Wipe from the center toward the outer circumference.



Handling precautions

- Do not take the CD from a cold to a warm environment, moisture may form on the CD. Wipe this off with a soft, dry, lint-free cloth before using the CD.
- Do not write on the label side with a ball-point pen or other writing instrument.
- Do not use record cleaning sprays, benzine, thinner, static electricity prevention liquids or any other solvent.
- Do not attach labels or stickers to CDs. (Do not use CDs with exposed adhesive from tape or left over peeled off stickers.)
- Do not use scratch-proof protectors etc.

Storage precautions

- Be sure to store CDs in their cases to protect them from dust, scratches, and warping.
- Do not place or store CDs in the following places**
- Locations exposed to direct sunlight
 - Humid or dusty locations
 - Locations directly exposed to a heat vent or heating appliance
 - In the glove compartment or on the rear deck of an automobile

Note on CD-R and CD-RW

This unit may not be able to play some CD-R due to the condition of the recording. It can not play CD-RW.

Portable CD player

Dear Customer

Thank you for purchasing this product. For optimum performance and safety, please read these instructions carefully.

The model number and serial number of this product can be found on either the back or the bottom of the unit.

Please note them in the space provided below and keep for future reference.

MODEL NUMBER SL-S292
SERIAL NUMBER _____

Operating Instructions

Model No. **SL-S292**



Supplied Accessories

Check the packing carton for these accessories.

Stereo headphones 1
(RFEV715P-KS)

Use numbers indicated in parentheses when asking for replacement parts.

To order accessories contact 1-800-332-5368 or web site
(<http://www.panasonic.com>).

Before connecting, operating or adjusting this product, please read these instructions completely. Please keep this manual for future reference.



Panasonic Consumer Electronics Company,
Division of Matsushita Electric Corporation of America

One Panasonic Way Secaucus, New Jersey 07094 <http://www.panasonic.com>
Panasonic Sales Company, Division of Matsushita Electric of Puerto Rico, Inc. ("PSC")
Ave. 65 de Infantería, Km. 9.5 San Gabriel Industrial Park, Carolina, Puerto Rico 00985
© 2001 Matsushita Electric Industrial Co., Ltd.



RQT6165-P

F0701TH0

Printed in Japan

IMPORTANT SAFETY INSTRUCTIONS

Read these operating instructions carefully before using the unit. Follow the safety instructions on the unit and the safety precautions listed below. Keep these operating instructions handy for future reference.

Safety

- Power source**—Connect the unit to a power source of the type described in these instructions or as marked on the unit.
- Polarization**—The unit is equipped with a polarized power plug where one blade is wider than the other. This safety feature ensures that the plug fits into your household AC outlet only one way. If the plug doesn't fit one way, try reversing it. If the plug still doesn't fit, contact an electrician to replace the obsolete outlet. Do not attempt to defeat the safety purpose of the plug.
- Power cord protection**—Route the AC power supply cord so that it will not be walked on or pinched by items placed on or against it. Never take hold of the plug or cord with wet hands. Always grasp the plug body firmly when connecting and disconnecting it.
- Overloading**—When connecting the AC power supply cord, be careful not to overload the household AC outlet, extension cord, or outlet from any other device as this can result in fire or electric shock.
- Nonuse periods**—Turn the unit off when it is not in use. Unplug the unit from the household AC outlet if it is not to be used for a long time. Unplug the unit during lightning storms. Leaving the unit connected to a household AC outlet for extended periods can cause battery fluid leakage.
- Attachments and accessories**—Use only the attachments and accessories recommended in these operating instructions.

Installation

Placement

- Foreign material**—Ensure objects and liquids do not get into the unit. Avoid exposing the unit to excessive smoke, dust, mechanical vibration, and shock.
- Magnetism**—Situate the unit away from equipment and devices that generate strong magnetic fields.
- Stacking**—Do not place anything on top of this unit.
- Wall and ceiling mounting**—Do not mount the unit on walls or ceilings unless specified in the instructions.

Environment

- Water and moisture**—Do not use the unit near water, such as near a bathtub or swimming pool. Avoid damp basements.
- Heat**—Situate the unit away from heat sources, such as radiators. Do not leave it in an automobile exposed to direct sunlight with the doors and windows closed as this may deform the cabinet. Do not situate where temperatures fall below 5 °C (41 °F) or rise above 35 °C (95 °F).

Maintenance

(See page 4 for details.)
Unplug the unit from the household AC outlet before cleaning.
Clean with a damp cloth.
Do not use abrasive pads, scouring powders, or solvents.

Service

- Damage requiring service**—The unit should be serviced by qualified service personnel if:
 - The AC power supply cord or AC adaptor has been damaged; or
 - Objects or liquids have gotten into the unit; or
 - The unit has been exposed to rain; or
 - The unit does not operate normally or exhibits a marked change in performance; or
 - The unit has been dropped or the cabinet damaged.
- Servicing**—Do not attempt to service the unit beyond that described in these operating instructions. Refer all other servicing to authorized servicing personnel.
- Replacement parts**—When parts need replacing ensure the servicer uses parts specified by the manufacturer or parts that have the same characteristics as the original parts. Unauthorized substitutes may result in fire, electric shock, or other hazards.
- Safety check**—After repairs or service, ask the servicer to perform safety checks to confirm that the unit is in proper working condition.



This manual was printed with soy based ink.

Power Supply Preparations

Refer to the specifications (page 6) for information on operating times when using rechargeable batteries or dry-cell batteries.

Using the AC adaptor (not included)

Be sure to obtain the optional AC adaptor **RP-AC46**. It is available through your Panasonic dealer.

Connect the AC adaptor.

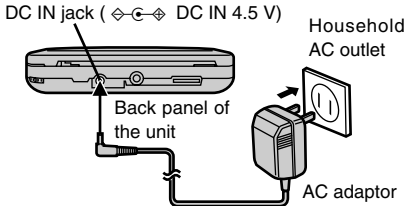

Conserving power

To save power when the unit is not to be used for a long time, unplug the AC adaptor from the household AC outlet. Reprogram tracks if necessary before use.

Using rechargeable batteries (not included)

Obtain the optional rechargeable batteries. Make sure to recharge the batteries before using them. The unit cannot be used to charge rechargeable batteries other than those specially designed for it.

- Optional batteries (P-3GAVA/2B)

Recharging procedure

- 1 Insert the special rechargeable batteries into the unit.

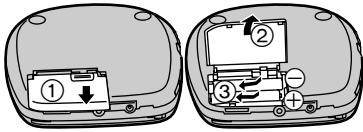

2 Connect the AC adaptor.

(Refer to "Using the AC adaptor" for connection instructions.)

Recharging starts and the "⏻" charging indicator flashes on and off on the unit's display. When the rechargeable batteries fully recharge the charging indicator disappears.

3 When recharging is complete, unplug the AC adaptor from the household AC outlet and the DC IN jack.

Note

- Rechargeable batteries have a service life of approximately 300 charge-discharge cycles. If the operating time on one full charge becomes noticeably shorter than it used to be, the battery has reached the end of its service life and should be replaced.
- Recharging may only be performed when the unit is powered off.
- The AC adaptor and rechargeable batteries may become warm while recharging is in progress. This is not a malfunction.

If the battery lid comes loose
Slide the lid back into place horizontally.

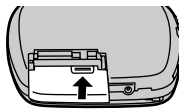

Removing batteries
Push up on the battery in the direction indicated by the arrow. Then lift it out.

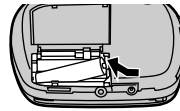

Using the car adaptor (not included)

Be sure to obtain the car adaptor (SH-CDC9), available as an optional accessory.

The car adaptor can be used to recharge the unit's batteries while in the car.

CAUTION:

Use only car adaptor, Model: SH-CDC9 manufactured by Matsushita Electric Industrial Co., Ltd.

Using dry-cell batteries (not included)

After disconnecting the AC adaptor, insert two "AA" (LR6) alkaline batteries.

The procedure for inserting and removing dry-cell batteries is identical to that for rechargeable batteries.

Battery indicator

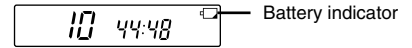

This indicator flashes on and off when the batteries are almost out of power. Power is cut off completely a short while later.

Rechargeable batteries: Recharge batteries.

Dry-cell batteries: Replace batteries with new ones.

Note

- The length of time the unit will continue to operate between when the battery indicator starts flashing and when the power is cut off differs depending on the type of batteries used.
- The battery indicator may not flash if rechargeable batteries other than those designated by Panasonic are used.

If the unit malfunctions or freezes during use, then disconnect the power sources (the AC adaptor and batteries). Re-connect the power source and continue operation.

HOLD Function

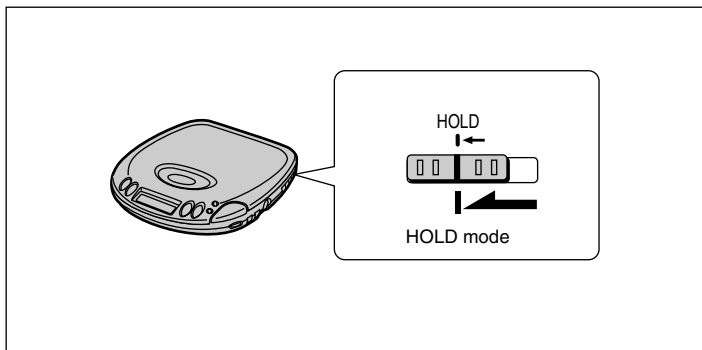

This function causes the unit to ignore short, accidental button presses. (The disc lid can still be opened and closed.)

The HOLD function prevents the following:

- Powering on the unit accidentally (which can cause the batteries to run down).
- Play being cut off unexpectedly in the middle of a selection.

To use the HOLD function

Set [HOLD] to the HOLD position.

"hold" indication

When the unit is in HOLD status, pressing any button (other than the OPEN button) causes the indication "hold" to appear on the display.

When the unit is powered off

The "hold" indication appears only when [▶||] is pressed.

Before operating the buttons

Be sure to move [HOLD] to release the unit from the hold mode.

Location of Controls

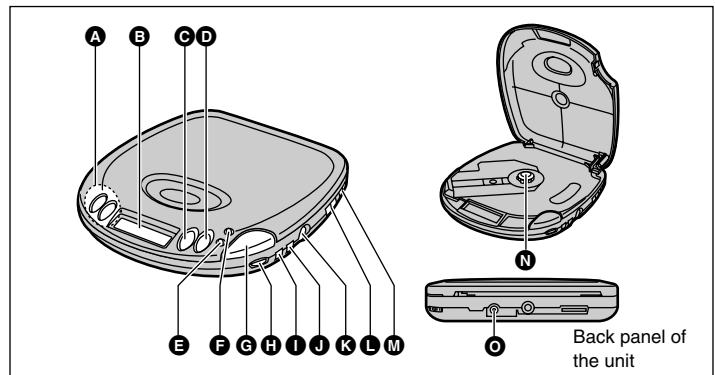

- A Skip/search buttons (◀◀, ▶▶)
- B Display
- C Stop/operation off button (■, OPR OFF)
- D Play/pause button (▶||)
- E Repeat button (↺)
- F Memory/recall button (MEMORY/RECALL)
- G Open button (OPEN)

- H Headphone volume control (VOLUME)
- I Anti-shock button (A.SHOCK)
- J S-XBS button (S-XBS)
- K Headphone jack (🔊)
- L Play mode selector (RESUME, RANDOM, NORMAL)
- M Hold switch (HOLD)
- N CD release button (PUSH)
- O DC IN jack (⚡ DC IN 4.5 V)

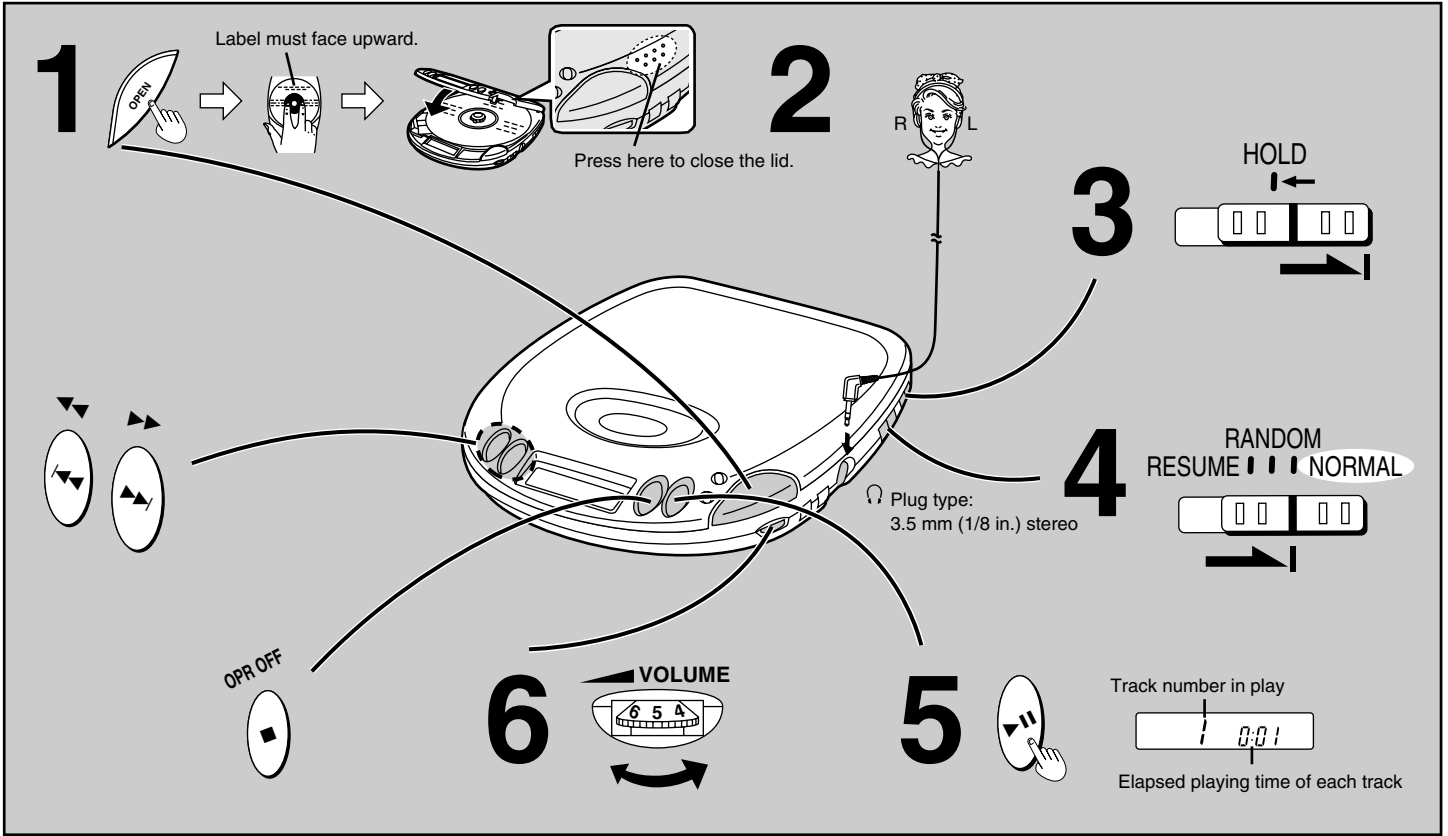

Follow steps 1–6.

In step 2, connect the stereo headphones to the ϕ jack. (Plug in firmly.)

- Play stops automatically when all the tracks have been played.
- If the unit has been connected to the car audio system, adjust the volume level between 4 and 6 on the unit, then adjust the volume level on the system.

For your reference:

“no disc” indication

This indication appears for about 30 seconds if [▶||] is pressed when no disc is loaded in the unit or if the disc is not properly secured.

“OPEN” indication

This indication appears for about 10 minutes when the cover is opened. (However, the indication does not appear when the unit is powered off.)

Note

Never insert foreign objects into the unit body.

Removing discs

- 1 Press [■,OPR OFF] to stop play and disc's rotation.
- 2 Press [OPEN] to open the lid.
- 3 Press [PUSH] to release the disc.

Do not stop the disc by hand or try to remove it before it stops rotating. This can damage CDs.

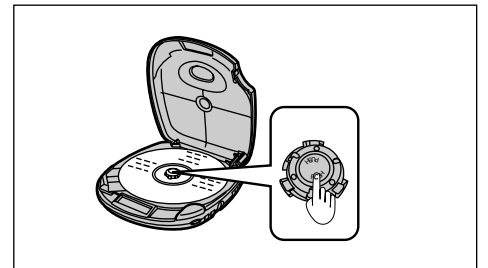

Auto power off function

If the unit is left in stop or paused status for approximately 10 minutes, the unit powers itself off automatically in order to prevent the battery from running down.
(If no disc is loaded in the unit, it powers itself off in about 30 seconds.)

Operation	Button	Display/reference
To pause play	Press during play.	 Press again to restart play.
To stop play Stop mode	Press during play. OPR OFF	Total number of tracks Total playing time
To turn off the unit Off mode	Press during stop mode. OPR OFF	
Skip forward/ backward (skip function)	Press during play. (Backward) (Forward) 	<ul style="list-style-type: none"> • During program play (page 4), these buttons are used to skip forward or back through the programmed sequence of tracks. • During random play (page 4), the skip buttons cannot be used to skip back to tracks that were played previously in the random sequence. • During program play, random play or 1-track repeat play (page 4), search operation is limited to the current track only.
Rapid forward/ backward (search function)	 Press and hold during play.	

Other Play Methods

The letters such as **A** in the various illustrations refer to the descriptions in the "Location of Controls" section (see page 2).

Skip play

The disc plays from the specific track through to the end, then play stops automatically.

Preparation: Put unit in stop mode.

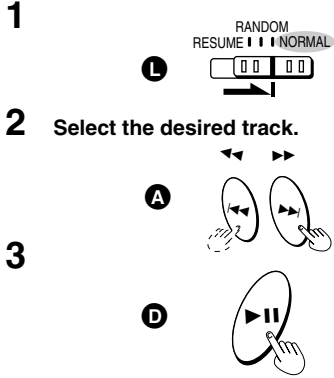

Random play

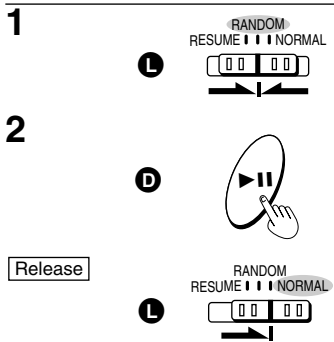

For your reference:

- It is also possible to press [▶▶] while the unit is in stop mode to change the first track to be played. (All tracks are played eventually, regardless of which is played first.)
- Program play is not possible in the random mode.

Resume play

This function allows you to listen from the beginning of the track where play stopped because the unit was powered off (or switched to stop mode). It is useful when listening to CDs in the car, etc.

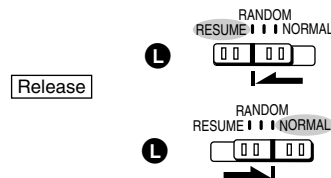

For your reference:

- If [RESUME, RANDOM, NORMAL] is put in the [RESUME] position, the all-track repeat function will be activated automatically as soon as the unit is powered on.
- If power is cut off near the end of a track (off mode), playback may resume from the beginning of the next track.
- If the unit is powered off while a disc was playing and then a new disc is inserted, play will begin from the middle of the new disc because the unit remembers the position where play stopped on the previous disc.

Program play

Up to 24 tracks can be entered in the programmed sequence.

Preparation: Put unit in stop mode.

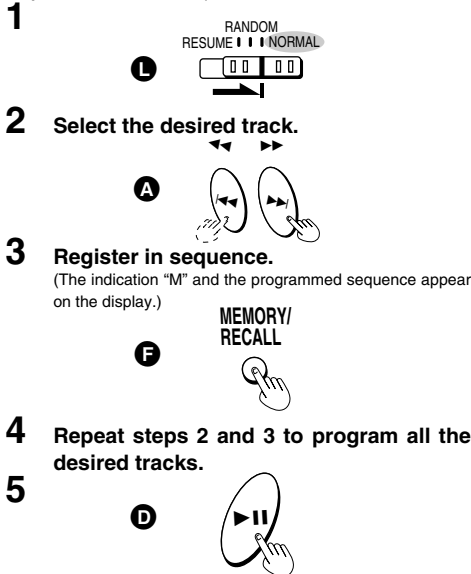

- To program the same track in the sequence more than once: After step 3, press [MEMORY/RECALL] desired number of times.
- If "F" is displayed: No more tracks can be programmed.
- To confirm the contents of the program: Press [MEMORY/RECALL] while the disc is playing. (The number of the programmed tracks appear on the display in sequence.)
- To delete the entire programmed sequence: Press [■, OPR OFF].

Repeat function

Press during play or stop mode.



The setting is switched in the sequence indicated below each time [E] is pressed.

- 1-track repeat (1): One track is repeated.
- All-track repeat (ALL): All the tracks on the disc are repeated.
- Cancel (no indicator is shown)

For your reference:

If [E] is pressed during program play, only the tracks in the program are repeated. (The indication "ALL" is not displayed.)

Changing the sound quality

Press during play or stop mode.



The setting switches in the sequence indicated below each time [S-XBS] is pressed.

- S-XBS → Cancel (no indicator is shown)

S-XBS:

Select this setting to boost the low-range response.

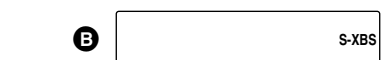

Anti-Shock Function (Anti-Skip System)

Anti shock works by reading audio data and storing it in memory. The unit then fills in interruptions caused by bumps and vibrations with data from the memory up to 10 seconds worth.

This unit also incorporates a powerful anti-shock mechanism that prevents skipping caused when play speed is changed by swinging of the unit.

Press during play or stop mode.

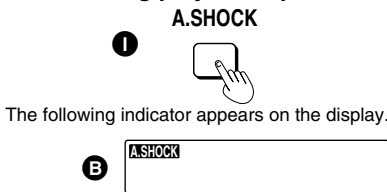

Note

If you have pressed [A.SHOCK] when the unit is in stop mode, press [▶▶] to start play.

When bumps continue repeatedly

The following indicator appears on the display and sound is interrupted.

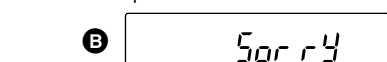

To cancel the anti-shock function

Press [A.SHOCK] again.

Note

- The anti-shock setting can be changed during play, but this may cause a slight interruption in the sound because the disc's rotation speed changes.
- During anti-shock operation, the disc rotates at a higher rate than usual to collect extra audio data. This could result in a slight increase in disc rotation noise.

Listening to sound with the unit connected to an audio system

The anti-shock function uses digital signal compression technology. It is recommended that the anti-shock function be canceled if the unit is connected to a home audio system.

Maintaining the Lens

Open the lid and clean the lens as shown in the figure. Use a cotton swab to gently wipe off any finger-prints. Recommended product: Lens cleaner kit (SZZP1038C)

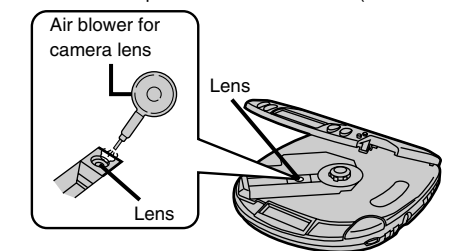

User memo:

DATE OF PURCHASE _____
 DEALER NAME _____
 DEALER ADDRESS _____
 TELEPHONE NUMBER _____

Parasonic Portable Audio Limited Warranty

Parasonic Consumer Electronics Company or Parasonic Sales Company (collectively referred to as "the Warrantor") will repair or replace this product with new or refurbished parts or equivalent product, free of charge in the U.S.A. or Puerto Rico, in the event of a defect in materials or workmanship as follows (all time periods commence from the date of original purchase) :

PARTS & LABOR - ONE (1) YEAR

Non-rechargeable batteries are not warranted

Rechargeable batteries - (when applicable) exchange defective item for new one for ten (10) days.

For assistance in the continental U.S.A. in obtaining repairs please ship the product to:

Parasonic Services Company - Customer Servicenter
Suite B 4900 George McVay Drive
McAllen, TX 78503

In Puerto Rico contact the Parasonic Sales Company.

Tel. (787) 750-4300 Fax. (787) 768-2910

When shipping the unit carefully pack and send it prepaid, adequately insured and preferably in the original carton. Include a letter detailing the complaint and provide a day time phone number where you can be reached.

IF REPAIR IS NEEDED DURING THE WARRANTY PERIOD THE PURCHASER WILL BE REQUIRED TO FURNISH A SALES RECEIPT/PROOF OF PURCHASE INDICATING DATE OF PURCHASE, AMOUNT PAID AND PLACE OF PURCHASE. CUSTOMER WILL BE CHARGED FOR THE REPAIR OF ANY UNIT RECEIVED WITHOUT SUCH PROOF OF PURCHASE.

Also, the purchaser will be responsible for shipping the unit to the above address.

If you have a problem with this product that is not handled to your satisfaction, then write to the Consumer Affairs Department at the Company address indicated above.

**For Product Information, Operating Assistance, Literature Request, Dealer Locations, and all Customer Service inquiries please contact:
1-800-211-PANA(7262), Monday - Friday 9 am - 9 pm, Saturday - Sunday 9 am - 7 pm, EST.**

Web Site: <http://www.panasonic.com>

You can purchase parts, accessories or locate your nearest servicenter by visiting our Web Site.

This warranty is extended only to the original purchaser.

This warranty only covers failures due to defects in materials and workmanship which occur during normal use. The warranty does not cover damage which occurs in shipment, or failures which are caused by products not supplied by the warrantor, or failures which result from accident, misuse, abuse, neglect, mishandling, faulty installation, misapplication, improper insertion of consumables, set-up adjustments, maladjustment of consumer controls, improper operation or maintenance, improper antenna, inadequate signal reception or pickup, alteration, modification, power line surge, improper voltage supply, lightning damage, commercial use or service by anyone other than a **PANASONIC SERVICES COMPANY** authorized repair facility, or damage that is attributable to acts of God.

LIMITS AND EXCLUSIONS

There are no express warranties except as listed above.

THE WARRANTOR SHALL NOT BE LIABLE FOR INCIDENTAL OR CONSEQUENTIAL DAMAGES (INCLUDING, WITHOUT LIMITATION, DAMAGE TO TAPES OR DISCS) RESULTING FROM THE USE OF THIS PRODUCTS, OR ARISING OUT OF ANY BREACH OF THE WARRANTY. ALL EXPRESS AND IMPLIED WARRANTIES, INCLUDING THE WARRANTIES OF MERCHANTABILITY AND FITNESS FOR PARTICULAR PURPOSE, ARE LIMITED TO THE APPLICABLE WARRANTY PERIOD SET FORTH ABOVE.

Some states do not allow the exclusion or limitation of incidental or consequential damages, or limitations on how long an implied warranty lasts, so the above exclusions or limitations may not apply to you.

This warranty gives you specific legal rights and you may also have other rights which vary from state to state.

Accessory Purchases:

1-800-332-5368 (Customer Orders Only)

Parasonic Services Company 20421 84th Avenue South, Kent, WA 98032 (6 am to 5 pm Monday - Friday; 6 am to 10:30 am Saturday, PST)
(Visa, MasterCard, Discover Card, American Express, Check)

Product Service

- 1. Damage requiring service**—The unit should be serviced by qualified service personnel if:
 - (a) The AC power supply cord or AC adaptor has been damaged; or
 - (b) Objects or liquids have gotten into the unit; or
 - (c) The unit has been exposed to rain; or
 - (d) The unit does not operate normally or exhibits a marked change in performance; or
 - (e) The unit has been dropped or the cabinet damaged.
- 2. Servicing**—Do not attempt to service the unit beyond that described in these operating instructions. Refer all other servicing to authorized servicing personnel.
- 3. Replacement parts**—When parts need replacing ensure the servicer uses parts specified by the manufacturer or parts that have the same characteristics as the original parts. Unauthorized substitutes may result in fire, electric shock, or other hazards.
- 4. Safety check**—After repairs or service, ask the servicer to perform safety checks to confirm that the unit is in proper working condition.

Product information

For product information or assistance with product operation:

Contact the Parasonic Customer Call Center at 1-800-211-7262,
or e-mail consumerproducts@panasonic.com,
or web site (<http://www.panasonic.com>).

For assistance in the continental U.S.A. in obtaining repairs please ship the product to:

Parasonic Services Company - Customer Servicenter
Suite B 4900 George McVay Drive
McAllen, TX 78503

In Puerto Rico contact the Parasonic Sales Company.

Tel. (787) 750-4300 Fax. (787) 768-2910

When shipping the unit carefully pack and send it prepaid, adequately insured and preferably in the original carton. Include a letter detailing the complaint and provide a day time phone number where you can be reached.

IF REPAIR IS NEEDED DURING THE WARRANTY PERIOD THE PURCHASER WILL BE REQUIRED TO FURNISH A SALES RECEIPT/PROOF OF PURCHASE INDICATING DATE OF PURCHASE, AMOUNT PAID AND PLACE OF PURCHASE. CUSTOMER WILL BE CHARGED FOR THE REPAIR OF ANY UNIT RECEIVED WITHOUT SUCH PROOF OF PURCHASE.

Also, the purchaser will be responsible for shipping the unit to the above address.

CAUTION:

This equipment has been tested and found to comply with the limits for a Class B digital device, pursuant to Part 15 of the FCC Rules.

These limits are designed to provide reasonable protection against harmful interference in a residential installation. This equipment generates, uses and can radiate radio frequency energy and, if not installed and used in accordance with the instructions, may cause harmful interference to radio communications. However, there is no guarantee that interference will not occur in a particular installation. If this equipment does cause harmful interference to radio or television reception, which can be determined by turning the equipment off and on, the user is encouraged to try to correct the interference by one or more of the following measures:

- Reorient or relocate the receiving antenna.
- Increase the separation between the equipment and receiver.
- Connect the equipment into an outlet on a circuit different from that to which the receiver is connected.
- Consult the dealer or an experienced radio/TV technician for help.

Any unauthorized changes or modifications to this equipment would void the user's authority to operate this device.

This device complies with Part 15 of the FCC Rules. Operation is subject to the following two conditions: (1) This device may not cause harmful interference, and (2) this device must accept any interference received, including interference that may cause undesired operation.

Using the Unit with Optional Accessories

Using the unit with an audio system

Using stereo connection cable (not included), you can hear CDs on your audio system.

- Connect the cable to the amplifier after turning off its power.
- Do not connect the cable to the PHONO jacks on the amplifier.
- Obtain the optional connecting cable if the amplifier comes with mini-phone jacks.
- Adjust the volume on the amplifier.
- Keep the unit's VOLUME control at a setting between 4 and 6.

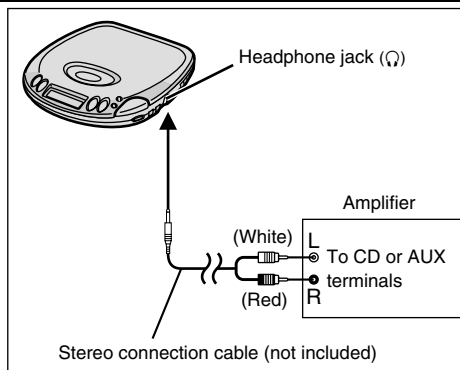

Using the unit with a car audio system

Items to be purchased

For connection to the car audio system and the power supply:

- Car stereo cassette adaptor (SH-CDM10A)
- Car adaptor (SH-CDC9)

Connect the car stereo cassette adaptor to the unit's headphone jack. (When doing this, keep the unit's VOLUME control at a setting between 4 and 6.)

Note

It may not be possible to use the unit with some types of car stereos owing to restrictions imposed by the construction of the car stereo cassette adaptor.

For further details, refer to the instructions of the part concerned.

Specifications

Audio (Anti-shock OFF)

No. of channels: 2 (left and right, stereo)
DA converter: 1 bit, MASH
Headphone output level: Max. 9 mW+9 mW/16 Ω (adjustable)

Pickup

Light source: Semiconductor laser
Wavelength: 780 nm

General

Operational temperature range: 0 °C–40 °C (32 °F–104 °F)

Rechargeable temperature range: 5 °C–40 °C (41 °F–104 °F)

Power supply: DC 4.5 V with optional AC adaptor RP-AC46

Play time:

[When used in hold mode, with S-XBS cancelled at 25 °C (77 °F), on a flat, stable surface]

Batteries used	Anti-shock OFF/ON
2 alkaline batteries	About 22 h/22 h
Optional rechargeable batteries (P-3GAVA/2B)	About 10 h/10 h

The play time may be less depending on the operating conditions.

Recharging time: About 5 hours

Dimensions (W×H×D):

128×25.8×144 mm

(5 1/8" × 1 1/2" × 5 1/4")

257 g (9.1 oz.)

(with batteries)

212 g (7.5 oz.)

(without batteries)

Note:

Specifications are subject to change without notice.
Mass and dimensions are approximate.

Troubleshooting Guide

Before requesting service, make the below checks. If you are in doubt about some of the check points, or if the remedies indicated in the chart do not solve the problem, **contact the Panasonic Customer Call Center at 1-800-211-7262, or e-mail consumerproducts@panasonic.com, or web site (<http://www.panasonic.com>).**

Problem	Check this
Cannot close the cover.	Is the disc properly secured in place?
Cannot play discs.	<ul style="list-style-type: none"> • Is the unit in HOLD status? • Is the disc properly secured in place? • Is there condensation on the lens? (Wait for about an hour and then try again.)
Cannot remove disc.	Did you press [PUSH] to release the disc?
Tracks on disc do not play in order, starting with the first track.	Is [RESUME, RANDOM, NORMAL] in the [NORMAL] position?
Cannot hear music—too noisy.	<ul style="list-style-type: none"> • Is the headphone plug inserted all the way? • Is the plug dirty? (Wipe away dirt on plug.) • Separate the unit from mobile phones.
TV picture is distorted. Radio reception is noisy.	Are you using the unit body too near a TV or tuner? (If the TV or tuner is connected to a simple indoor antenna, connect it to an outdoor antenna.)

Cautions

Listening caution



Do not play your headphones or earphones at a high volume. Hearing experts advise against continuous extended play.

If you experience a ringing in your ears, reduce volume or discontinue use.

Do not use while operating a motorized vehicle. It may create a traffic hazard and is illegal in many areas.

You should use extreme caution or temporarily discontinue use in potentially hazardous situations.

Even if your headphones or earphones are the open-air type designed to let you hear outside sounds, don't turn up the volume so high that you can't hear what's around you.

Sound can be deceiving. Over time your hearing "comfort level" adapts to higher volumes of sound. So what sounds "normal" can actually be loud and harmful to your hearing.

Guard against this by setting your equipment at a safe level BEFORE your hearing adapts. To establish a safe level:

- Start your volume control at a low setting.
- Slowly increase the sound until you can hear it comfortably and clearly, and without distortion.

Once you have established a comfortable sound level:

- Set the dial and leave it there.

Discontinue use if you experience discomfort with the headphones. Continued use may cause rashes or other allergic reactions.

Selection and care of rechargeable /dry cell batteries

Selection

As a safety precaution, the portable CD players made by Panasonic are constructed so it is impossible to recharge ordinary batteries.

Only batteries especially designed for this unit can be recharged.

Special rechargeable Ni-Cd batteries:

P-3GAVA/2B (set of 2)

For details, check with your dealer.

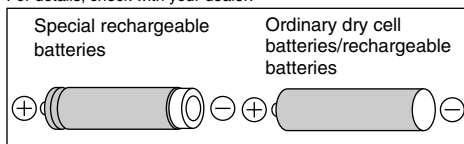

• If rechargeable battery play time is short after recharging, the batteries have reached the end of their service life. Replace them with the recommended replacements.

• Play time may be shorter than usual after recharging batteries for the first time or after they have been unused for a long time. Repeatedly recharge and discharge the batteries if this occurs to restore them to normal.

WARNING:

TO REDUCE THE RISK OF FIRE, ELECTRIC SHOCK OR PRODUCT DAMAGE, DO NOT EXPOSE THIS APPARATUS TO RAIN, MOISTURE, DRIPPING OR SPLASHING AND THAT NO OBJECTS FILLED WITH LIQUIDS, SUCH AS VASES, SHALL BE PLACED ON THE APPARATUS.

Care

To prevent battery damage, electrolyte leakage and short-circuiting, heed the following points.

- Do not peel off the covering on batteries and do not use if the covering has been peeled off.
- Align the poles ⊕ and ⊖ correctly when inserting the batteries.
- Do not mix different types or makes of batteries or old and new batteries.
- Remove the batteries if you do not intend to use the unit for a long time.
- Do not throw into fire, short-circuit, disassemble, or subject to excessive heat.
- Do not attempt to recharge dry cell batteries.
- Do not allow metal objects to touch the battery terminals as this may cause short-circuiting which is dangerous.
- When carrying batteries in a pocket or bag, ensure no metal objects such as necklaces are placed together with them. Contact with metal may cause short-circuiting which can cause a fire. For safety, carry the rechargeable batteries in the battery carrying case.

When driving a car

In the interest of traffic safety, do not operate the unit while driving.

CAUTION!

THIS PRODUCT UTILIZES A LASER. USE OF CONTROLS OR ADJUSTMENTS OR PERFORMANCE OF PROCEDURES OTHER THAN THOSE SPECIFIED HEREIN MAY RESULT IN HAZARDOUS RADIATION EXPOSURE. DO NOT OPEN COVERS AND DO NOT REPAIR YOURSELF. REFER SERVICING TO QUALIFIED PERSONNEL.